

TECHNISCHE DOKUMENTATION



KBS Gastrotechnik GmbH – Schoßbergstraße 26 – 65201 Wiesbaden



T8

Quick Guide



T8 Quick Guide



Turn on method

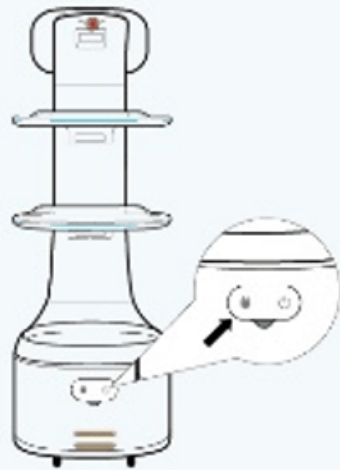

2. Below the Back of the robot.
Find the silicone Lid.

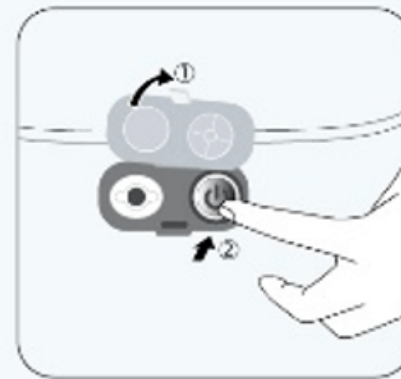

3. Open the lid and press silver.
Turn on the circular switch.

T8 Quick Guide



The robot won't turn on

1. No power - Charge with Charging Piles

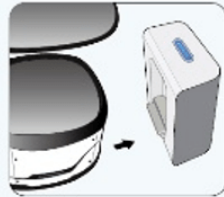

Push the robot on the charging pile

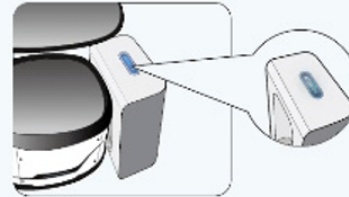

Green light of the charging pile indicates its charging

2. No power – Adaptor charging

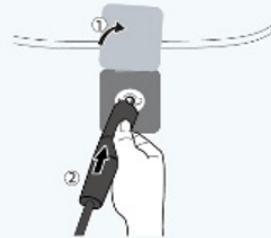

Open the Back Cover and Plug-in into the Charging port

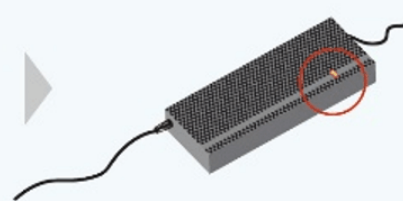

Red light of the adaptor indicates that it is charging

T8 Quick Guide



Cleaning the sensors



In order to make the robot work properly
Please keep stereo vision and radar clean
and tidy.

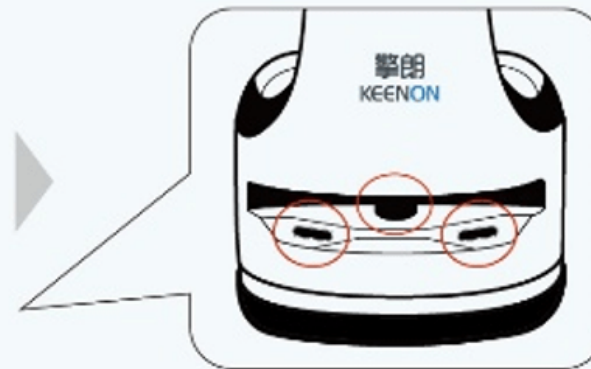

If there is any dirt, please use alcohol cotton or
glasses cloth .
Gently wipe the part. It is recommended to clean
it once a week regularly.

T8 Quick Guide



The robot won't auto-charge

1. No Power – Adaptor charging



The power supply is not plugged in (or finally plugged-in)
The charging pile indicator light is not on.

When the power is on, the charging pile will show a blue light.

T8 Quick Guide



The robot won't auto-charge

2 . Charging pile was displaced, causing the robot to find the charging point .

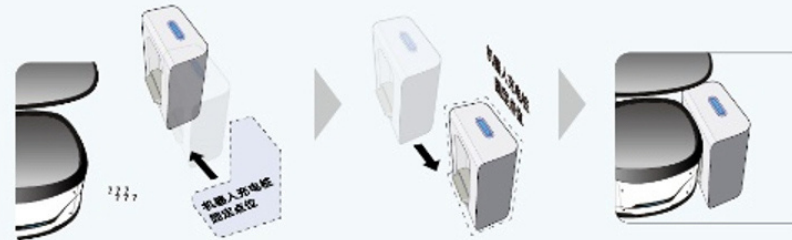

As shown in the figure, the fixed point of the charging pile is moved to the left, and the charging pile needs to be put back in place before the robot can charge normally.

3 . There are obstacles Infront of the charging pile.

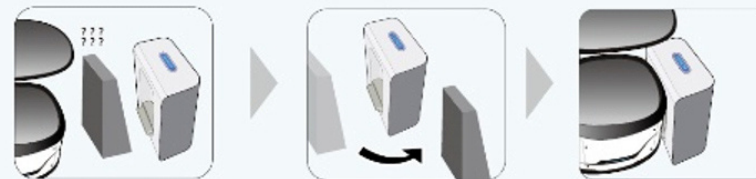

As shown, there is a box on the way to charge the application pile, which makes it impossible to be recharged.

Remove obstacles and normalize.

T8 Quick Guide



The robot won't operate

1. Report the failure that the route can not be found



Report route failure
Because the robot is not within the labelling range.

2 Robot vision is Blocked.



The robot reported that the labels can't be seen

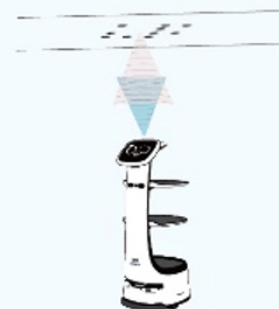

The robot needs to be pushed under the labelled.
If the robot restarts and turns on, it will return to normal.



Because there are obstacles that block the vision above the head, it is normal to remove the obstacles.



Thanks

