

# EXPLOSIONSZEICHNUNG

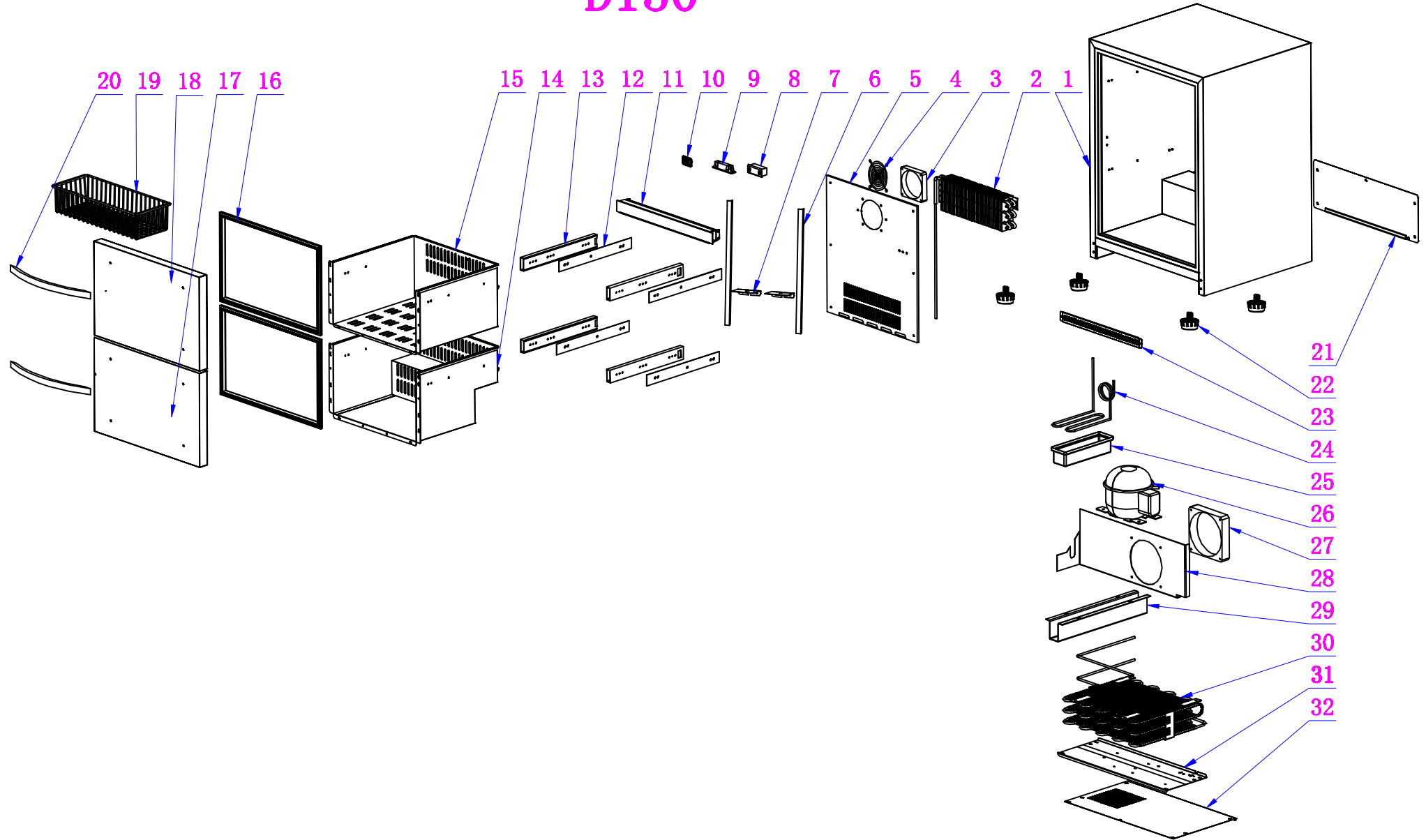

KBS Gastrotechnik GmbH – Schoßbergstraße 26 – 65201 Wiesbaden

# D150



serial no		name	material no	qty
1		cabinet	D150001000	1
2		evaporator	C138005013	1
3		evaporator fan	C138005009	1
4		fan cover	C390F05003	1
5		evaporator fan installation plate	D150005006	1
6		fan installation plate	C145W05001	2
7		evaporator air clapboard	C138005019	2
8		digital controller	C138006003	1
9		LED light	C138006008	1
10		sensor cover	C138006010	1
11		middle post	D150008000	1
12		guide rail subplate	D150004010	4
13		left and right guide rail	D150004008	4
14		bottom drawer	D150004007	1
15		upper drawer	D150004006	1
16		drawer gasket	D150004005	2
17		bottom drawer door	D150004000	1
18		upper drawer door	D150004000	1
19		basket	D150004016	1
20		handle	D150004020	2
21		back grill	C138005002	1
22		foot	SS10005037	4
23		kick plate	D150005002	1
24		drip tray evaporating pipe	C184F05026	1
25		drip tray	C184F05025	1
26		compressor	C138005019	1
27		condenser fan	C138005009	1
28		fan holder	D150005009	1
29		condenser clapboard	D150005003	1
30		condenser	D150005004	1
31		compressor base plate	C138005001	1
32		bottom seal plate	C138005A03	1